

Types with white silicone coating on the food vulcanized steel braid

Suction and discharge of any product

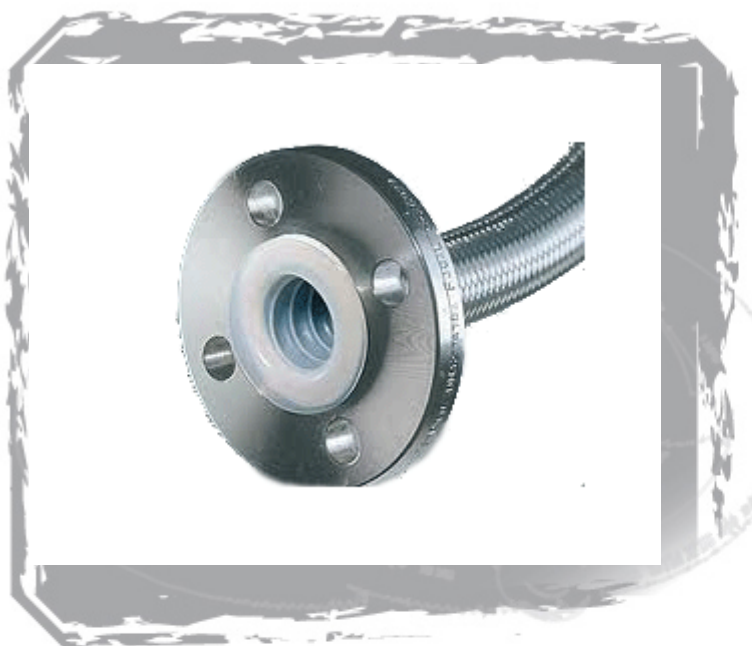

The PTFE hose-CH (convoluted helical) long wave comes in 4 different versions depending on the quality of the sheath and the proposed reinforcements.

With a threaded connections made by a thermoforming aseptic in our workshops, **the fluid is in contact only with PTFE.**

This feature gives a wide variety of applications.

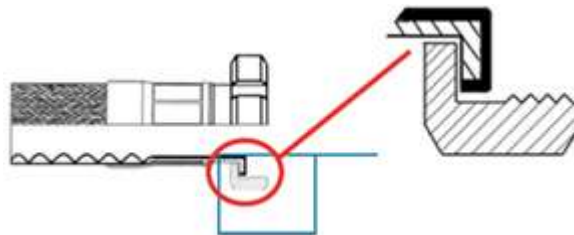

Caractéristiques techniques :

Inner tube:

Two qualities of inner sleeve are available:

- Pure white inner sleeve
- Inner sleeve with carbon black

Siding:

External protection is available in two versions:

- Stainless steel braid
- Braided high strength synthetic

The reinforcement is possible with a coil steel for vacuum applications

Temperature:

- 70 ° C to + 260 ° C

Spécifications techniques :

Diamètre Intérieur	RC (mm)	PS (Bar)	Diamètre Intérieur	RC (mm)	PS (Bar)
6	18	172	16	51	83
8	25	155	19	64	69
10	22	138	25	89	46
13	25	103	32	125	34

Raccords usuels * (mâle ou femelle) :



Le montage coté tuyau pourra être **serti en version standard ou aseptique**

Tout autre type de raccord sur demande

Nous nous réservons le droit de modifier nos produits et nos gammes à tout moment afin de les améliorer